

TYPE CAN

Features

- Manufactured from high strength copper tubing
- Compact design
- Range taking
- Circuit bars inserted at a 20 angle
- Copper conductor only

Benefits

- Provides maximum conductivity
- Up to 42 circuit taps can be made in just 5 1/2" of space
- A wide range of conductor sizes can be used in the same connector
- Provides easy wire insertion

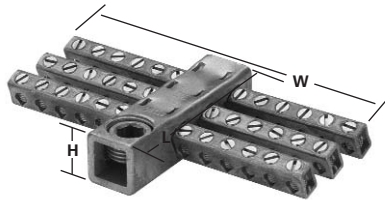

Fig. 1



Fig. 2



Fig. 3



Fig. 4

Catalog Number	Figure Number	Number Of Taps	Wire Range		Dimensions			
			Main	Tap	L	Height With Maximum Wire	W	Two Tapped Mounting Holes
CAN-300	1	24	250kcmil-6	6-14	2-5/16	1-5/16	5-1/8	10-32
CAN-301	1	30	250kcmil-6	6-14	3	1-5/16	4-13/32	10-32
CAN-302	1	36	250kcmil-6	6-14	3	1-5/16	5-1/8	10-32
CAN-303	1	42	250kcmil-6	6-14	3	1-7/16	5-1/2	10-32
R-16	2	Mounting block of general purpose (phenolic black) suitable for mounting any of CAN Neutrals. 2-1/2" wide x 2-1/2" long x 1" thick.						
E-223	3	10-32 x 1/2" round head steel machine screws for fastening neutrals to mounting blocks. (Use lock washer to provide rigid assembly.)						
E-153	3	1/4-28 wire pressure screw 7/16" long. Screw is steel, zinc plated and chromate dipped.						
N-174	4	Supplied in 5' 9" lengths. Approximately 174 outlets. Wire range 14-6.						

All wire sizes, unless noted otherwise, are American Wire Gauge (AWG)
Tested to UL 486A/B, UL File E6207



TYPE CAN

Features

- Manufactured from high strength copper tubing
- Compact design
- Range taking
- Circuit bars inserted at a 20 angle
- Copper conductor only

Benefits

- Provides maximum conductivity
- Up to 42 circuit taps can be made in just 5 1/2" of space
- A wide range of conductor sizes can be used in the same connector
- Provides easy wire insertion

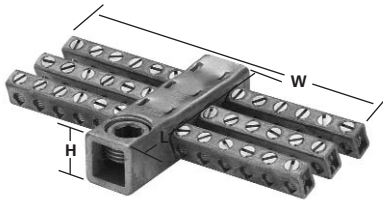

Fig. 1



Fig. 2



Fig. 3



Fig. 4

Catalog Number	Figure Number	Number Of Taps	Wire Range		Dimensions			
			Main	Tap	L	Height With Maximum Wire	W	Two Tapped Mounting Holes
CAN-300	1	24	250kcmil-6	6-14	2-5/16	1-5/16	5-1/8	10-32
CAN-301	1	30	250kcmil-6	6-14	3	1-5/16	4-13/32	10-32
CAN-302	1	36	250kcmil-6	6-14	3	1-5/16	5-1/8	10-32
CAN-303	1	42	250kcmil-6	6-14	3	1-7/16	5-1/2	10-32
R-16	2	Mounting block of general purpose (phenolic black) suitable for mounting any of CAN Neutrals. 2-1/2" wide x 2-1/2" long x 1" thick.						
E-223	3	10-32 x 1/2" round head steel machine screws for fastening neutrals to mounting blocks. (Use lock washer to provide rigid assembly.)						
E-153	3	1/4-28 wire pressure screw 7/16" long. Screw is steel, zinc plated and chromate dipped.						
N-174	4	Supplied in 5' 9" lengths. Approximately 174 outlets. Wire range 14-6.						

All wire sizes, unless noted otherwise, are American Wire Gauge (AWG)
Tested to UL 486A/B, UL File E6207

K

TYPE CAN

Features

- Manufactured from high strength copper tubing
- Compact design
- Range taking
- Circuit bars inserted at a 20 angle
- Copper conductor only

Benefits

- Provides maximum conductivity
- Up to 42 circuit taps can be made in just 5 1/2" of space
- A wide range of conductor sizes can be used in the same connector
- Provides easy wire insertion

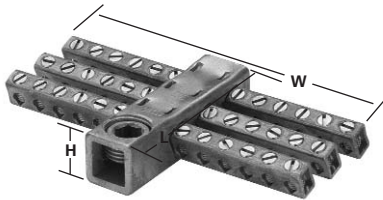

Fig. 1



Fig. 2



Fig. 3



Fig. 4

Catalog Number	Figure Number	Number Of Taps	Wire Range		Dimensions			
			Main	Tap	L	Height With Maximum Wire	W	Two Tapped Mounting Holes
CAN-300	1	24	250kcmil-6	6-14	2-5/16	1-5/16	5-1/8	10-32
CAN-301	1	30	250kcmil-6	6-14	3	1-5/16	4-13/32	10-32
CAN-302	1	36	250kcmil-6	6-14	3	1-5/16	5-1/8	10-32
CAN-303	1	42	250kcmil-6	6-14	3	1-7/16	5-1/2	10-32
R-16	2	Mounting block of general purpose (phenolic black) suitable for mounting any of CAN Neutrals. 2-1/2" wide x 2-1/2" long x 1" thick.						
E-223	3	10-32 x 1/2" round head steel machine screws for fastening neutrals to mounting blocks. (Use lock washer to provide rigid assembly.)						
E-153	3	1/4-28 wire pressure screw 7/16" long. Screw is steel, zinc plated and chromate dipped.						
N-174	4	Supplied in 5' 9" lengths. Approximately 174 outlets. Wire range 14-6.						

All wire sizes, unless noted otherwise, are American Wire Gauge (AWG)
Tested to UL 486A/B, UL File E6207